

| | | | | |
|----|-------|--------------|------|------|
| NR | CN NR | MODIFICATION | DATE | SIGN |
|----|-------|--------------|------|------|

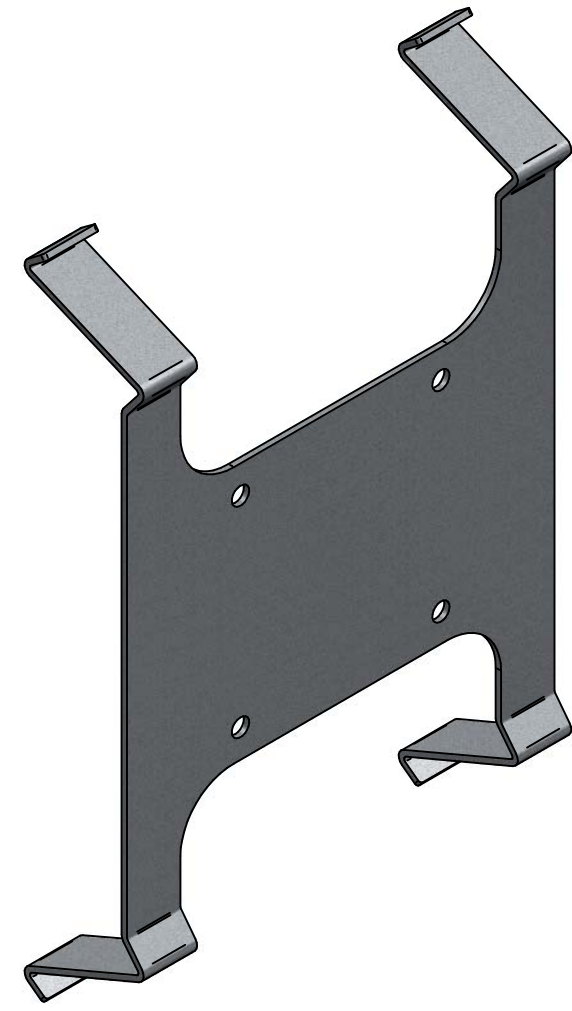
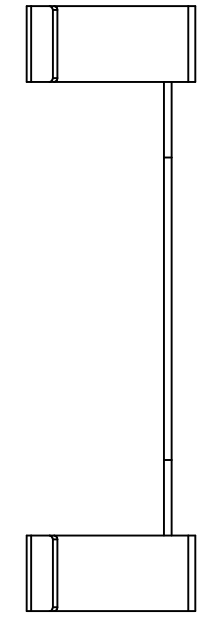
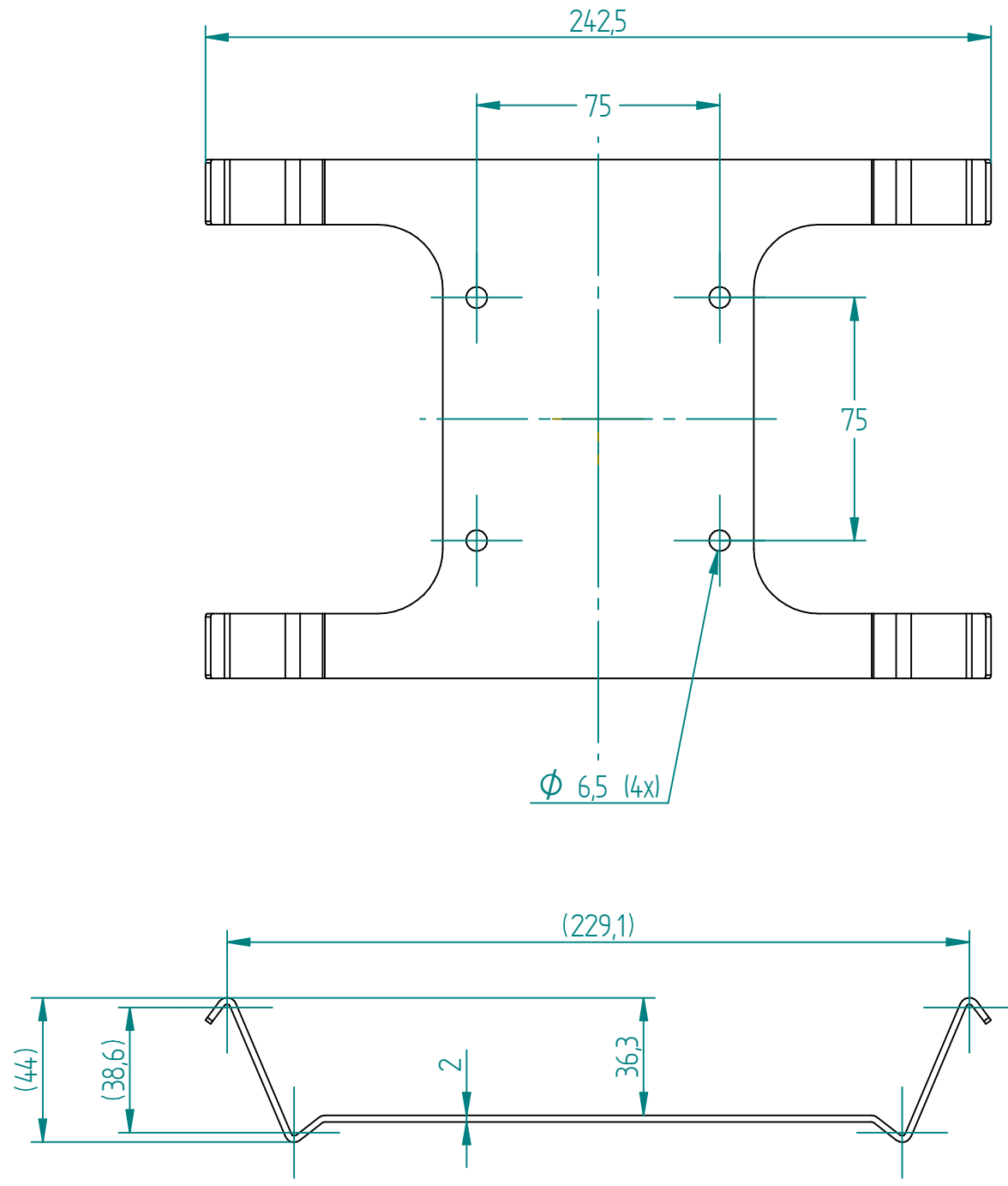

A
B
C
D
E
F
G

Solid 3-D cad model is made nominal without tolerances.
Form tolerance  unless otherwise stated.

Model file name: C000 154-65rA.stp
Unbent geometri according to C000 154-65rA.dxf

THIS DRAWING IS THE PROPERTY OF CROSSCONTROL. PROTECTED IN ACCORDANCE WITH PREVAILING LAW.

| | | | |
|----------------------------------|-----------------|------------------------------|-------------------------------------|
| Stainless steel 2331-14 | | - | - |
| MATERIAL | | DIMENSION | SURFACE TREATMENT |
| GENERAL TOLERANCE | | GENERAL SURFACE FINISH Ra | RoHS COMPLIANT DIRECTIVE 2002/95/EC |
| SS-ISO 2768-1 c | | Passivated ISO 16048 | Yes |
| CHECKED UWM | APPROVED SHN | NAME | PRODUCT |
| DRAWN TWL | DATE 2021-07-02 | Mounting bracket V1000/V1200 | |
| DRAWING NO | | SHEET | |
| crosscontrol crosscontrol.com | | C000 154-65 | |
| | | 1 (2) REVISION A | |

1 2 3 4 5 6 7 8 9 10

| | | | | |
|----|-------|--------------|------|------|
| NR | CN NR | MODIFICATION | DATE | SIGN |
|----|-------|--------------|------|------|

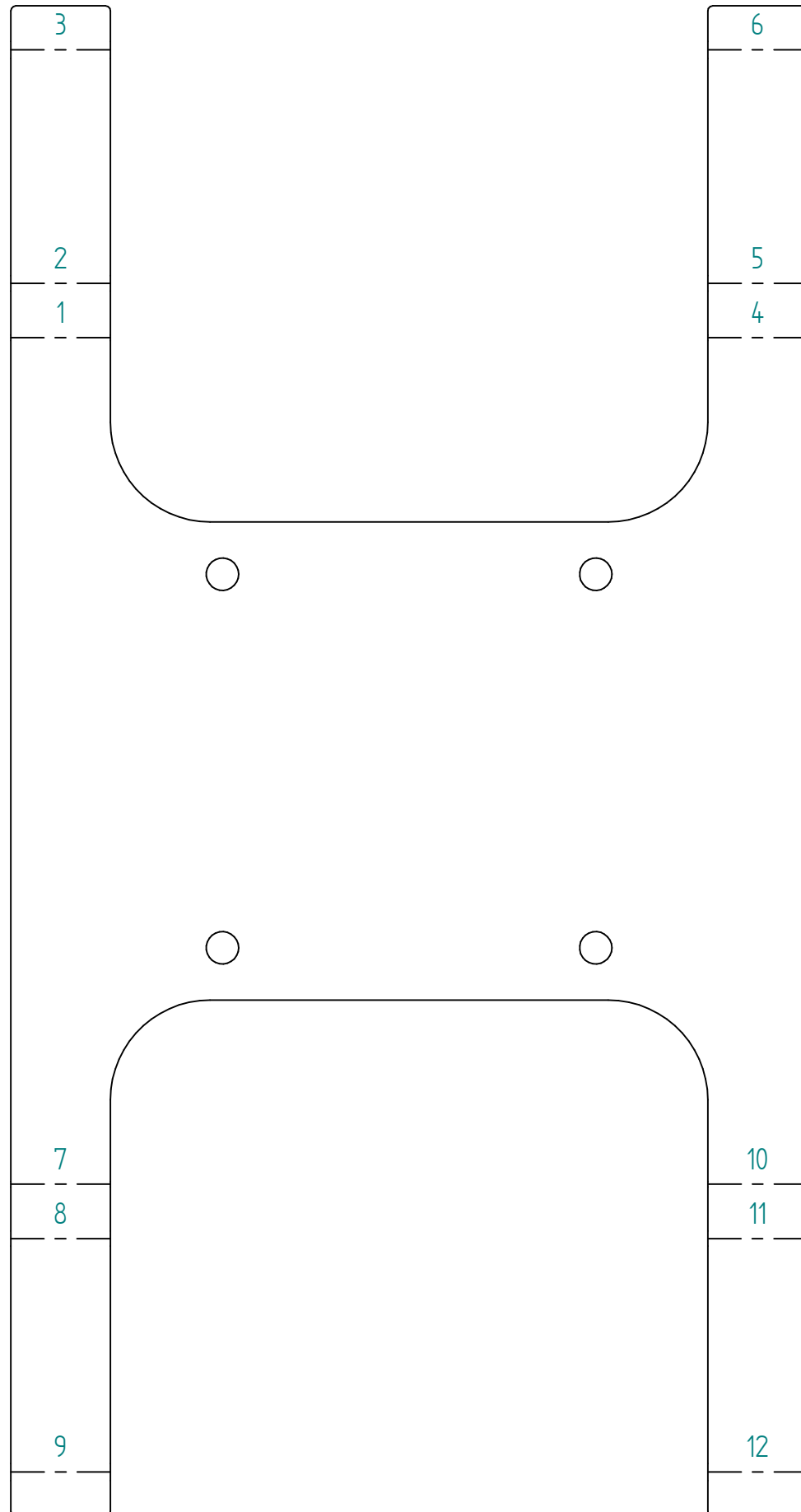

| Sequence | Feature | Radius | Angle | Direction | Included Angle |
|----------|----------|---------|------------|-----------|----------------|
| 1 | Flange 1 | 1,00 mm | 38,00 deg | Up | 142,00 deg |
| 2 | Flange 2 | 1,00 mm | 105,00 deg | Down | 75,00 deg |
| 3 | Flange 3 | 1,00 mm | 120,00 deg | Up | 60,00 deg |
| 4 | Mirror 1 | 1,00 mm | 38,00 deg | Up | 142,00 deg |
| 5 | Mirror 1 | 1,00 mm | 105,00 deg | Down | 75,00 deg |
| 6 | Mirror 1 | 1,00 mm | 120,00 deg | Up | 60,00 deg |
| 7 | Mirror 2 | 1,00 mm | 38,00 deg | Up | 142,00 deg |
| 8 | Mirror 2 | 1,00 mm | 105,00 deg | Down | 75,00 deg |
| 9 | Mirror 2 | 1,00 mm | 120,00 deg | Up | 60,00 deg |
| 10 | Mirror 2 | 1,00 mm | 38,00 deg | Up | 142,00 deg |
| 11 | Mirror 2 | 1,00 mm | 105,00 deg | Down | 75,00 deg |
| 12 | Mirror 2 | 1,00 mm | 120,00 deg | Up | 60,00 deg |

Unbent geometri according to C000 154-65rA.dxf

| | | | |
|-------------------------|--------------------|------------------------------|-------------------------------------|
| Stainless steel 2331-14 | | - | - |
| MATERIAL | | DIMENSION | SURFACE TREATMENT |
| GENERAL TOLERANCE | | GENERAL SURFACE FINISH Ra | RoHS COMPLIANT DIRECTIVE 2002/95/EC |
| SS-ISO 2768-1 c | | Passivated ISO 16048 | Yes |
| CHECKED UWM | APPROVED SHN | NAME | PRODUCT |
| DRAWN TWL | DATE 2021-07-02 | Mounting bracket V1000/V1200 | |
| DRAWING NO | | SHEET | |
| C000 154-65 | | 2 (2) | |
| | | REVISION | |
| | | A | |

THIS DRAWING IS THE PROPERTY OF CROSSCONTROL. PROTECTED IN ACCORDANCE WITH PREVAILING LAW.

A
B
C
D
E
F
G